

The ADSL microfilter allows the transmission of the voice signal, (low pass band filter) and avoids the transmission of the ADSL signal to the phone or other equipment connected to the output. The voice signal keeps a high quality without distortions or noises.

The maximum number of microfilters that can be installed in the same line is 3, if higher an HR splitter must be used.

**MFAT101** - To be used in conventional lines (POTS) and without billing tone. It is not necessary to use an auxiliary (T) RJ11.

**Countries:** Australia, Belgium, Bulgaria, Canada, Cyprus, Holland, Ireland, Check Republic, Sweden, Tunes.



- Ready for new ADSL 2 + technology.
- Plastic material (Fireproof).
- RJ11 connector with gold covering (50µm)
- Exclusive design
- Designed according environment regulation ETS300019 part.1-1, class1.2; part1-2, class2.3; part.1-3, class3.2

### Technical requirements

Voice specifications		General specifications	
Pass band (P.b.)	0-4 KHz	Resistance in loop	< 50 Ω
Line impedance	150nf / 750 Ω + 270 Ω	Line/ground isolation resistance	> 100 M Ω
Insertion losses in (B.p.)	< 0,32dB	Isolation resistance line	> 10 M Ω
Distortion of insert losses in (B.p.)	< 0,5 dB	Line connectors	Cable 15cm with RJ11 connector
Return losses to 200Hz : 1MFA - (3MFA)	> 10,2 dB - (>10,2DdB)	Phone connectors	1 RJ11
Return losses to 3,5KHz : 1MFA - (3MFA)	> 12 dB - (>10,5 dB)	ADSL data connectors	1 RJ11
Return losses to 4,4KHz : 1MFA - (3MFA)	> 14 dB - (>12,5 dB)	Surface mounting	Adhesive tape
ADSL band attenuation (32 KHz – 2,2 MHz)	> 20 dB	Dimensions	(59x27x23) mm
Maximum current (Imax) d.c.	100 mA	Weight	35 gr

### Installation and connections

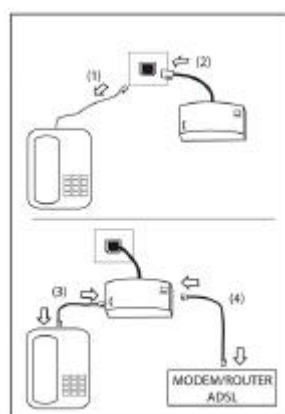
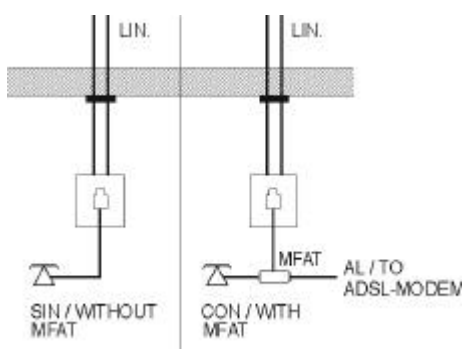

#### Installation diagram

The microfilter ADSL T must be placed in the line entrance where you wish to connect the MODEM or ADSL router. As shown in the diagram. With the T microfilter there is no need to use an auxiliary (T) RJ11.

#### Installation process

- 1- Unplug the phone cable from the line output.
- 2- Connect the microfilter MFAT to the line output.
- 3- Connect the telephone to the microfilter (telephone)
- 4- Connect the MODEM or router to the microfilter (Data)

#### It contains

- Microfilter MFAT101
- Adhesive tape
- Installation instructions